



64 - 66 Great Western Highway Parramatta NSW

1  1  1 

Open, unrestricted views of Parramatta City skyline. Brilliant views from every room. Bright, east facing 1 bedroom apartment. Perfectly positioned above Parramatta's CBD. 5th floor. Spacious living area leading to huge covered balcony with panoramic views.

Large bedroom with built-in robe. Internal laundry. Quiet, peaceful outlook on high level. Security building with intercom and lift access. Secure underground car space included. Well maintained complex with modern refurbished foyers, lovely tranquil grounds, resort style swimming pool & plenty of visitor parking.

This superbly located unit is in the heart of Parramatta City.

[For full version visit the website](https://www.ddrealestate.com.au)

Type : Unit
Price : \$ 320,000
Building Size : 57 sqm
Land Size : 70.4 sqm
View : <https://www.ddrealestate.com.au/1718134>



D&D - Commercial Sales and Leasing
02 9687 6555

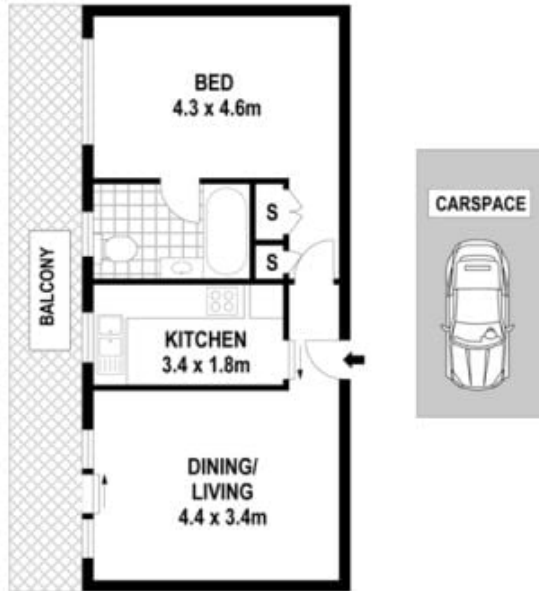

Scale in metres. Indicative only. Dimensions are approximate. All information contained herein is gathered from sources we believe to be reliable. However we cannot guarantee its accuracy and interested persons should rely on their own enquiries.



26/64-66 Great Western Highway, Parramatta