



**24 Pennant Hills Road NORTH PARRAMATTA NSW**

2  1  1 

2 bedroom unit in small, quiet complex. Beautiful parquetry timber floors throughout. Sunny balcony overlooking parkland. Freshly painted with new blinds. Large main bedroom with open views over North Parramatta. Spacious kitchen. Large internal laundry. Bathroom with separate bath & shower.

Secure building with intercom. Designated off street car space. Across street from picturesque Richie Benaud Oval. Enjoy walks around historic Belmore Park with nature reserves, sporting fields & children's play equipment.

Bus stop at door step with easy access to Parramatta CBD, Westfield shopping & station. 10 minute walk to Parramatta

[For full version visit the website](https://www.ddrealestate.com.au)

**Type** : Unit  
**Building Size** : 67 sqm  
**Land Size** : 81 sqm  
**View** : <https://www.ddrealestate.com.au/1180251>



**D&D - Commercial Sales and Leasing**  
**02 9687 6555**

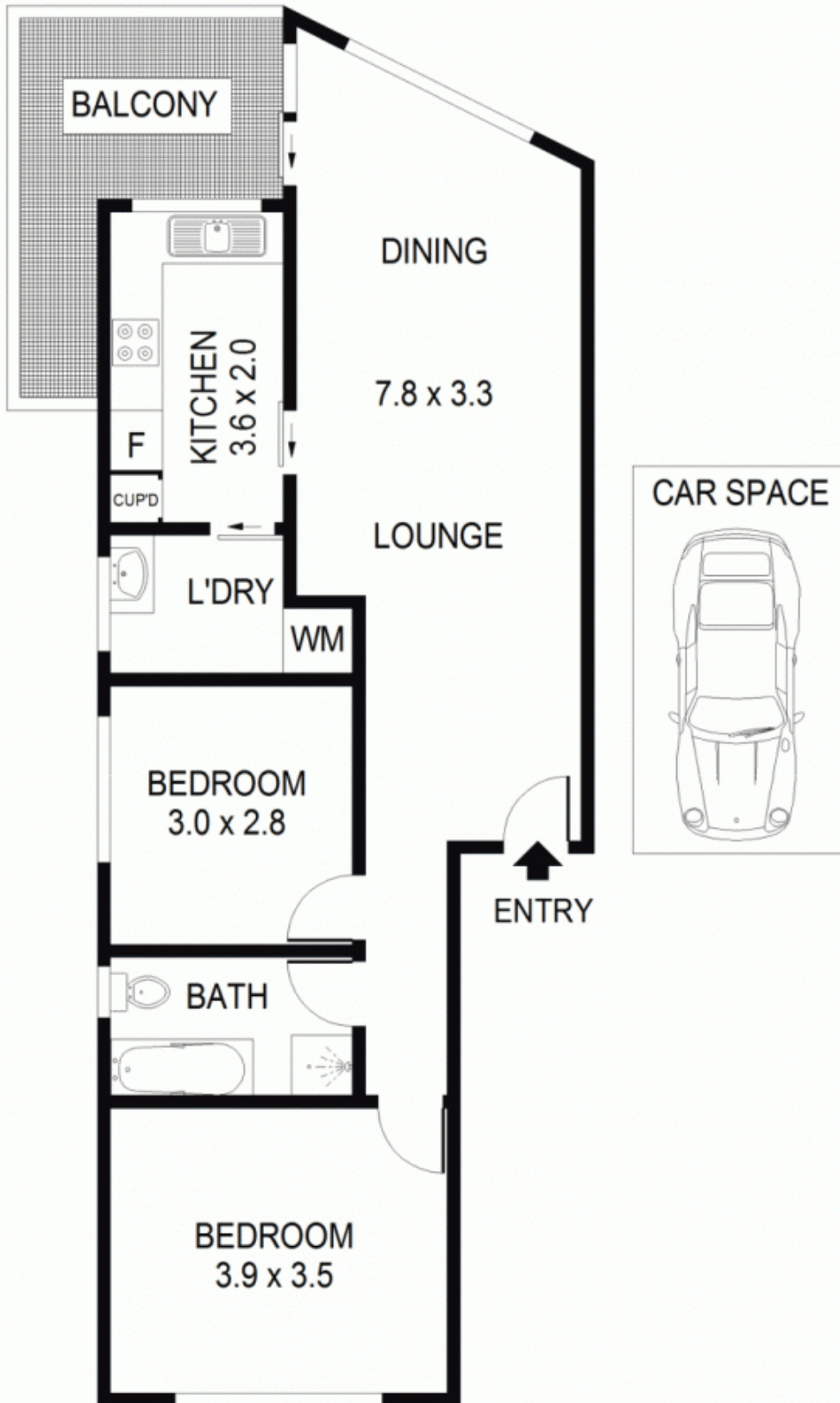

Scale shown in metres. All dimensions herein are approximate and gathered from sources believed to be reliable. Whilst every effort is made for the accuracy of our floor plans, interested parties should rely on their own enquires. Floor Plans by Industrie Media | [industriemedia.tv](http://industriemedia.tv)

S1

2/24 Pennant Hills Road, North Parramatta